

# 湛江市霞山区2026年度第十批次城镇建设 用地勘测界定图

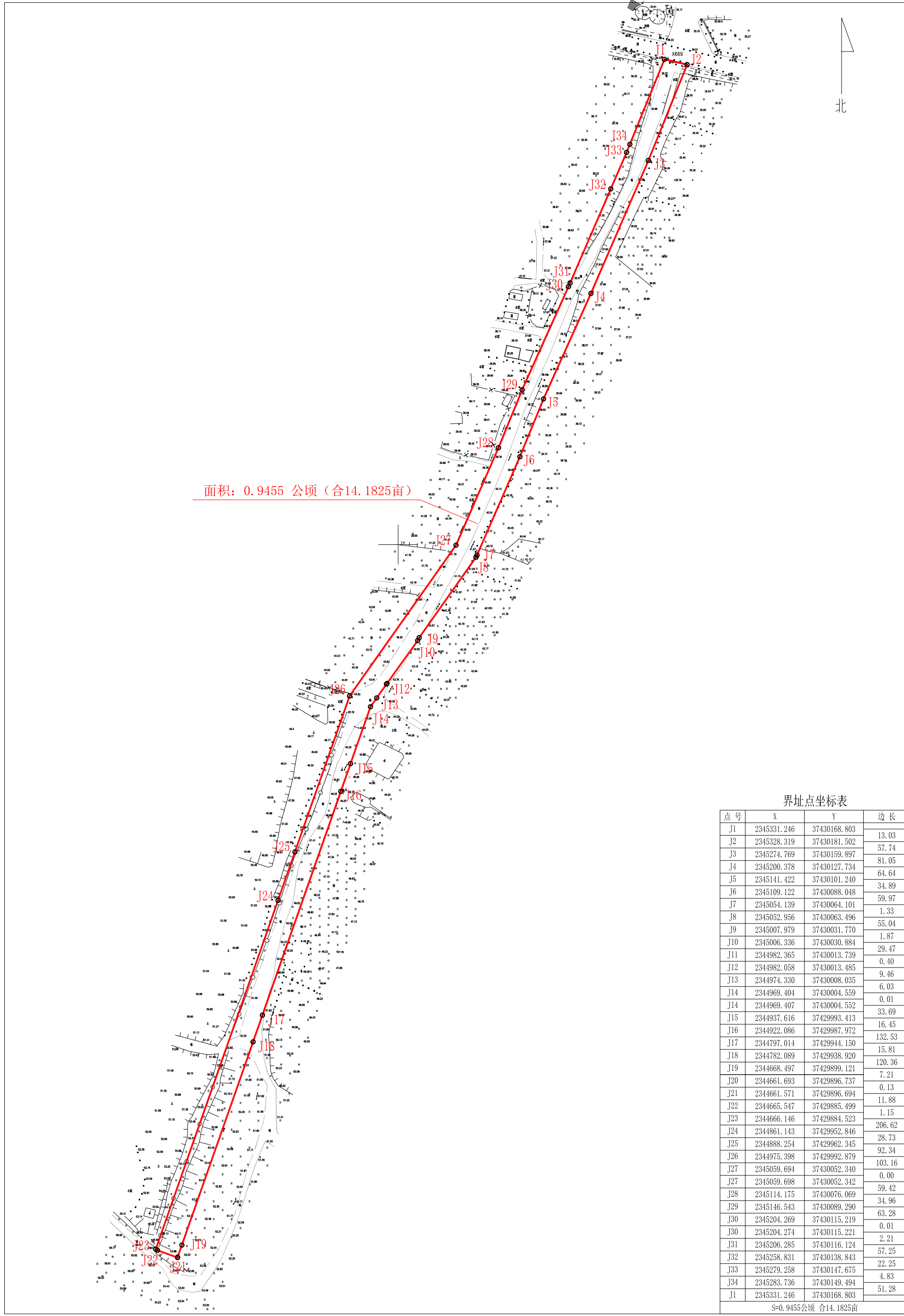

面积: 0.9455 公顷 (合14.1825亩)

界址点坐标表

| 点号                   | X           | Y            | 边长     |
|----------------------|-------------|--------------|--------|
| J1                   | 2345331.246 | 37430168.803 |        |
| J2                   | 2345328.319 | 37430181.502 | 13.03  |
| J3                   | 2345274.769 | 37430159.897 | 57.74  |
| J4                   | 2345200.378 | 37430127.734 | 81.05  |
| J5                   | 2345141.422 | 37430101.240 | 64.64  |
| J6                   | 2345109.122 | 37430088.048 | 34.89  |
| J7                   | 2345054.139 | 37430064.101 | 59.97  |
| J8                   | 2345052.956 | 37430063.496 | 1.33   |
| J9                   | 2345007.979 | 37430031.770 | 55.04  |
| J10                  | 2345006.336 | 37430030.884 | 1.87   |
| J11                  | 2344982.365 | 37430013.739 | 29.47  |
| J12                  | 2344982.058 | 37430013.485 | 0.40   |
| J13                  | 2344974.330 | 37430008.035 | 9.46   |
| J14                  | 2344969.404 | 37430004.559 | 6.03   |
| J14                  | 2344969.407 | 37430004.552 | 0.01   |
| J15                  | 2344937.616 | 37429993.413 | 33.69  |
| J16                  | 2344922.086 | 37429987.972 | 16.45  |
| J17                  | 2344797.014 | 37429944.150 | 132.53 |
| J18                  | 2344782.089 | 37429938.920 | 15.81  |
| J19                  | 2344668.497 | 37429899.121 | 120.36 |
| J20                  | 2344661.693 | 37429896.737 | 7.21   |
| J21                  | 2344661.571 | 37429896.694 | 0.13   |
| J22                  | 2344665.547 | 37429885.499 | 11.88  |
| J23                  | 2344666.146 | 37429884.523 | 1.15   |
| J24                  | 2344861.143 | 37429952.846 | 206.62 |
| J25                  | 2344888.254 | 37429962.345 | 28.73  |
| J26                  | 2344975.398 | 37429992.879 | 92.34  |
| J27                  | 2345059.694 | 37430052.340 | 103.16 |
| J27                  | 2345059.698 | 37430052.342 | 0.00   |
| J28                  | 2345114.175 | 37430076.069 | 59.42  |
| J29                  | 2345146.543 | 37430089.290 | 34.96  |
| J30                  | 2345204.269 | 37430115.219 | 63.28  |
| J30                  | 2345204.274 | 37430115.221 | 0.01   |
| J31                  | 2345206.285 | 37430116.124 | 2.21   |
| J32                  | 2345258.831 | 37430138.843 | 57.25  |
| J33                  | 2345279.258 | 37430147.675 | 22.25  |
| J34                  | 2345283.736 | 37430149.494 | 4.83   |
| J1                   | 2345331.246 | 37430168.803 | 51.28  |
| S=0.9455公顷 合14.1825亩 |             |              |        |

2000国家大地坐标系。  
1985国家高程基准。  
GB/T20257.1-2017国家基本比例尺地图图式。  
2026年05月数字化制图。  
1:2000